

QUICK-DISCONNECTS

TMDEN
TMEDN : Nylon
TMDN

■ FULLY INSULATED
FEMALE DISCONNECTS

■ 110 SERIES

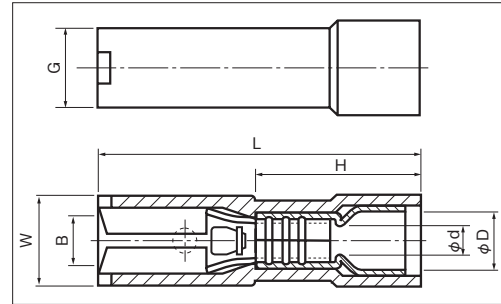

RoHS 10
See page 2

PART NUMBER	DIMENSIONS mm							MATING TAB THICKNESS mm	WIRE RANGE		TOOL No.		STD COLOR	STD QTY/BOX
	B	W	L	φd	φD	G	H		STRANDED mm ²	AWG	HAND TOOL No. TOOL BODY No. DIES No.			
TMDEN 280509-FA	3.2	5.5	19.5	1.9	3.4	4.8	10.0	0.5	0.75~1.25	18-16	NH 11 NH 32	RED TRANSLUCENT	1,000 (100×10)	
TMDEN 280809-FA											NA 10 NA 3			N10 11 N3 11

■ 187 SERIES

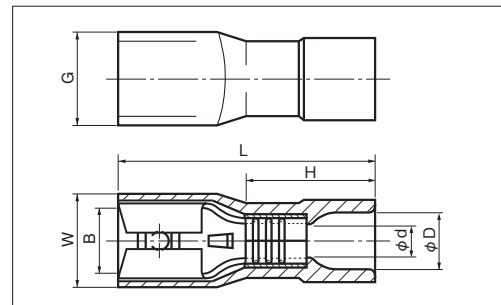

RoHS 10
See page 2

PART NUMBER	DIMENSIONS mm							MATING TAB THICKNESS mm	WIRE RANGE		TOOL No.		STD COLOR	STD QTY/BOX
	B	W	L	φd	φD	G	H		STRANDED mm ²	AWG	HAND TOOL No. TOOL BODY No. DIES No.			
TMEDN 480509-FA ○	5.0	7.2	19.5	1.8	4.1	4.85	9.8	0.5	0.75~1.25	18-16	NH 11 NH 32	RED TRANSLUCENT	1,000 (100×10)	
TMEDN 480809-FA ○											NA 10 NA 3			N10 11 N3 11
TMEDN 480520-FA ○	5.0	7.2	19.5	2.4	4.5	5.6	9.8	0.5	2.0	14	NH 12 NH 32	BLUE TRANSLUCENT	1,000 (100×10)	
TMEDN 480820-FA ○											NA 10 NA 3			N10 12 N3 12

■ 250 SERIES

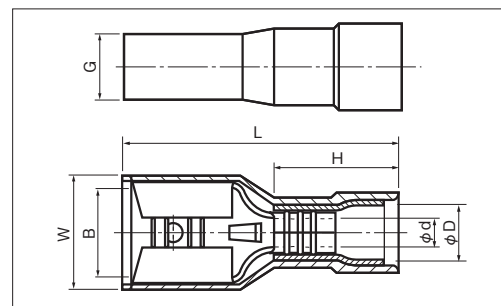

RoHS 10
See page 2

RoHS 10
Yellow Nylon
See page 2

PART NUMBER	DIMENSIONS mm							MATING TAB THICKNESS mm	WIRE RANGE		TOOL No.		STD COLOR	STD QTY/BOX
	B	W	L	φd	φD	G	H		STRANDED mm ²	AWG	HAND TOOL No. TOOL BODY No. DIES No.			
TMDN 630809-FA △	6.8	9.0	21.0	1.7	3.2	4.9	9.5	0.8	0.75~1.25	18-16	NH 11 NH 32	RED TRANSLUCENT	1,000 (100×10)	
TMDN 630820-FA △											NA 10 NA 3			N10 11 N3 11
TMDN 630855-FA △	6.8	9.0	21.0	2.4	3.9	5.2	9.5	0.8	2.0	14	NH 12 NH 32	BLUE TRANSLUCENT	1,000 (100×10)	
TMDN 630820-FA △											NA 10 NA 3			N10 12 N3 12
TMDN 630855-FA △	6.8	9.2	26.0	3.5	5.4	5.8	15.0	0.8	5.5	10	NH 13	YELLOW TRANSLUCENT	500 (100×5)	
TMDN 630855-FA △											NA 10 NA 3			N10 13 N3 13

NOTE 1) ○ : UL/CSA △ : UL

2) Refer to page 71 for UL/CSA, proper strip length of wire and Nylon insulated products.